



Park West Building, The Bow Quarter

Offers In Excess Of £500,000 Leasehold

OLIVER  JACQUES
EST. 1986



Park West Building, The Bow Quarter

Oliver Jaques presents a 2-bedroom, 2-bathroom corner apartment located in the Park West building of the Bow Quarter development. Situated at the end of the block, this property benefits from light entering the property from multiple aspects with double bedrooms overlooking the landscaped communal gardens and large living room with uninterrupted views of the courtyard and water fountain. The apartment also boasts a modern galley kitchen and separate office.

The Bow Quarter development offers various amenities to its residents including 24 hour concierge and security, large communal roof terrace, on-site postal office, on-site convenience store, leisure facilities including 15 meter swimming pool, stream room, sauna and fully equipped gym.

Local transport links include the DLR from Bow Church, Circle, District and Hammersmith and City lines from Bow Road and Central and district lines from Mile End station. There are also various bus routes immediately outside the development.

- Two Bedroom Apartment
- Triple Aspect
- Leisure Facilities
- En-suite Master bedroom
- Secure Parking
- Separate Office

Oliver Jaques Bow Sales
020 8980 0999

Email southeast@o-j.co.uk

Unit A Arlington Building, London, E3 2UB

web <https://www.o-j.co.uk/>

Every care has been taken with the preparation of this brochure but it is for general guidance only and complete accuracy cannot be guaranteed. If there is any point, which is of importance professional verification should be sought. This brochure does not constitute a contract or part of a contract. We are not qualified to verify tenure of property. Prospective purchasers should seek clarification from their solicitor or verify the tenure of this property for themselves by visiting www.gov.uk/government/organisations/land-registry. The mention of any appliances, fixtures or fittings does not imply they are in full working order. Photographs are reproduced for general information and it cannot be inferred that any item shown is included in the sale. All dimensions are approximate. Walking times are taken from Google Maps and measured from the centre of the postcode, which may differ from the individual property. We routinely refer clients to Chancery Mortgage Services Ltd. It is your decision whether you choose to deal with Chancery Mortgage Services Ltd. In making that decision, you should know that we receive an annual payment benefits from Chancery Mortgage

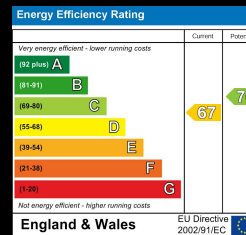

England & Wales

Fairfield Road, London, E3

Approximate Area = 789 sq ft / 73.3 sq m
For identification only - Not to scale

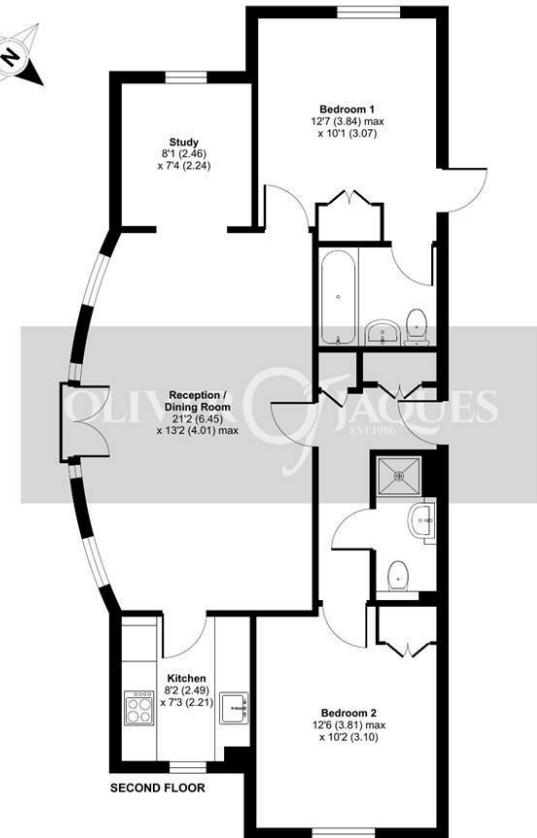

Floor plan produced in accordance with RICS Property Measurement Standards incorporating International Property Measurement Standards (IPMS2 Residential). © nchcom 2023. Produced for Oliver Jaques. REF: 1036465

Tenure: Leasehold

Ground Rent: £10

Service Charge: c. £5,400 p/a

Lease Expires: 2203 (180 years)

Shared Ownership: No

Council Tax Band: Tower Hamlets (Band E)
£1,932.37